

FEATURES

- **Size Range:** 1/2" through 12"
- **Material:** Carbon steel
- **Finish:** Plain, Electroplated Galvanized.
- **Function:**
 - Designed for supporting and stabilizing vertical pipe runs.
 - Clamp is fitted for steel pipe and preferably installed below a coupling or shear lugs.
- **Temperature:** Maximum temperature Plain 650°F, Galvanized 450°F.
- **Standard:** Complies with Federal Specifications A-A-1192A (Type8) and ANSI/SP-69 and SP -58 (Type 8).
- **Approval:** UL listed 1/2" through 8"
FM approved 3/4" through 8"

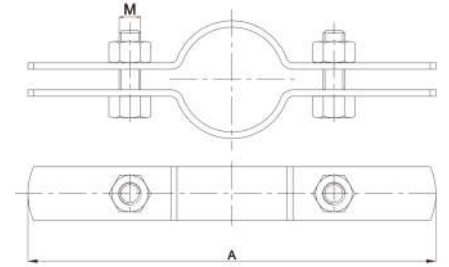

SIZE

Material: Carbon Steel

Unit: Inch

| FirmFX # | PIPE SIZE | A | M | Static load (lbs) | Certifications |
|------------|-----------|---------|------|-------------------|----------------|
| FX70PS0050 | 1/2" | 8.504" | 3/8" | 220 | / |
| FX70EG0050 | 1/2" | 8.504" | 3/8" | 220 | UL |
| FX70PS0075 | 3/4" | 8.976" | 3/8" | 220 | / |
| FX70EG0075 | 3/4" | 8.976" | 3/8" | 220 | UL/FM |
| FX70PS0100 | 1" | 8.976" | 3/8" | 220 | / |
| FX70EG0100 | 1" | 8.976" | 3/8" | 220 | UL/FM |
| FX70PS0125 | 1-1/4" | 9.449" | 3/8" | 250 | / |
| FX70EG0125 | 1-1/4" | 9.449" | 3/8" | 250 | UL/FM |
| FX70PS0150 | 1-1/2" | 9.842" | 3/8" | 250 | / |
| FX70EG0150 | 1-1/2" | 9.842" | 3/8" | 250 | UL/FM |
| FX70PS0200 | 2" | 10.551" | 3/8" | 300 | / |
| FX70EG0200 | 2" | 10.551" | 3/8" | 300 | UL/FM |
| FX70PS0250 | 2-1/2" | 11.024" | 3/8" | 400 | / |
| FX70EG0250 | 2-1/2" | 11.024" | 3/8" | 400 | UL/FM |
| FX70PS0300 | 3" | 11.732" | 3/8" | 500 | / |
| FX70EG0300 | 3" | 11.732" | 3/8" | 500 | UL/FM |

Material: Carbon Steel

Unit: Inch

| FirmFX # | PIPE SIZE | A | M | Static load (lbs) | Certifications |
|------------|-----------|---------|------|-------------------|----------------|
| FX70PS0350 | 3-1/2" | 12.638" | 3/8" | 600 | / |
| FX70EG0350 | 3-1/2" | 12.638" | 3/8" | 600 | UL/FM |
| FX70PS0400 | 4" | 12.953" | 1/2" | 750 | / |
| FX70EG0400 | 4" | 12.953" | 1/2" | 750 | UL/FM |
| FX70PS0500 | 5" | 14.252" | 1/2" | 1500 | / |
| FX70EG0500 | 5" | 14.252" | 1/2" | 1500 | UL/FM |
| FX70PS0600 | 6" | 15.512" | 1/2" | 1600 | / |
| FX70EG0600 | 6" | 15.512" | 1/2" | 1600 | UL/FM |
| FX70PS0800 | 8" | 18.268" | 5/8" | 2500 | / |
| FX70EG0800 | 8" | 18.268" | 5/8" | 2500 | UL/FM |
| FX70PS1000 | 10" | 20.1" | 5/8" | 2500 | / |
| FX70EG1000 | 10" | 20.1" | 5/8" | 2500 | / |
| FX70PS1200 | 12" | 22.375" | 5/8" | 2700 | / |
| FX70EG1200 | 12" | 22.375" | 5/8" | 2700 | / |

FEATURES

- **Size Range:** 1/2" through 6"
- **Material:** Carbon steel
- **Finish:** Copper Colored Epoxy
- **Function:**
 - Designed for supporting and stabilizing vertical pipe runs.
 - Clamp is fitted for copper pipe and preferably installed below a coupling or shear lugs.
- **Temperature:** Maximum temperature 210°F.
- **Standard:** Complies with Federal Specification WW-H-171 (Type 8)

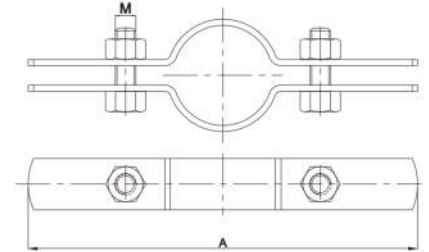

SIZE

Material: Carbon Steel

Unit: Inch

| FirmFX # | PIPE SIZE | A | M | Static load (lbs) | Certifications |
|------------|-----------|----------|------|-------------------|----------------|
| FX70CE0050 | 1/2" | 8-1/2" | 3/8" | 75 | / |
| FX70CE0075 | 3/4" | 9-1/4" | 3/8" | 75 | / |
| FX70CE0100 | 1" | 9-5/16" | 3/8" | 120 | / |
| FX70CE0125 | 1-1/4" | 9-1/2" | 3/8" | 150 | / |
| FX70CE0150 | 1-1/2" | 9-5/8" | 3/8" | 150 | / |
| FX70CE0200 | 2" | 10-7/16" | 3/8" | 150 | / |
| FX70CE0250 | 2-1/2" | 11-3/16" | 3/8" | 300 | / |
| FX70CE0300 | 3" | 12" | 3/8" | 300 | / |
| FX70CE0400 | 4" | 12-1/2" | 3/8" | 300 | / |
| FX70CE0600 | 6" | 15-1/8" | 1/2" | 600 | / |